

SAMSUNG HOSPITALITY DISPLAYS HF690U SERIES (North America)

HIGHLIGHTS

- Deliver high quality content with UHD resolution
- Develop and deploy compatible web applications within powerful Tizen OS
- Showcase powerful content securely through the integrated H.Browser
- Tailor individual home menus to suit guests' personalized needs
- Develop and share personalized content through the centralized LYNK REACH 4.0 server
- Synchronize multiple displays for more efficient management using the LYNK HMS Server



UHD-QUALITY CONTENT DELIVERY



HF690U displays leverages TIZEN OS's rigorous three-layer protection to ensure content security across application, platform and system. The integrated H.Browser can render and upload 2D/3D content securely and at a faster pace.

SIMPLE, COMPATIBLE WEB APP DEVELOPMENT



Hotel managers can leverage TIZEN to build and deploy customizable home menu that suits their brand and operational needs. Both staffs and guests can enjoy the convenience of an intuitive, easy-to-navigate interface.

CENTRALIZED, REAL-TIME MANAGEMENT



LYNK REACH 4.0's centralized, real-time monitoring can detect and troubleshoot issues before they become issues for guests. Compatibility with LAN, Wi-Fi and coaxial infrastructures drives more effective management and monitoring.

CONVENIENT AND THOROUGH ROOM MANAGEMENT

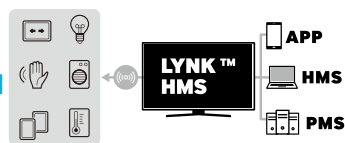

LYNK HMS allows staff to view maintenance needs and energy usage for efficient and convenient room management. This platform also shares an interface where guests can control multiple in-room components from a single source.

POWERFUL GRAPHIC PERFORMANCE WITH ENHANCED SECURITY



Samsung's H.Browser empowers fast and accurate application development. Through a host of TIZEN-based tools, developers can test each application's security and performance prior to launch, and safely store them within the OS.

A TAILORED HOME MENU FOR GUESTS

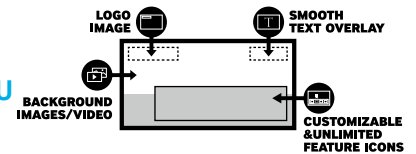

An integrated Ethernet bridge turns the display into a mobile office, accommodating a variety of business needs. As the workday ends, guests also can leverage the display to relax by streaming TV or music.

END-TO-END PERSONALIZED SERVICE



As guests arrive, hotels can deploy personalized welcome message and relevant promotional items through LYNK REACH 4.0's customized content offerings. They also can express checkout to ensure a pleasant conclusion to any stay.

DELIGHT GUESTS AT A REDUCED COST

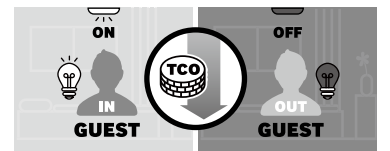

LYNK HMS delivers pleasant and memorable guest experience in a more cost-efficient manner. Hotel operators can streamline content delivery property-wide while also managing heat and air activity based on room occupancy.

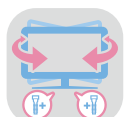

SWIVEL STAND



ETHERNET BRIDGE



PLUG AND PLAY



BLUETOOTH MUSIC PLAYER



CONTENT SHARING (MOBILE TO TV MIRRORING, SMART VIEW)



SECURITY MODE



LYNK DRM



SOUND BAR COMPATIBILITY



SI COMPATIBILITY

SPECIFICATIONS

| MODEL | | 43NF69U HG43NF690UF | 50NF69U HG50NF690UF | 55NF69U HG55NF690UF | 65NF69U HG65NF690UF | 75NF69U HG75NF690UF |
|---------------------|---------------------------------|--|--|--|--|--|
| Display | Backlight | LED | LED | LED | LED | LED |
| | Inch (Real Inch) | 43 | 50 | 55 | 65 | 75 |
| | Resolution | 3,840 × 2,160 | 3,840 × 2,160 | 3,840 × 2,160 | 3,840 × 2,160 | 3,840 × 2,160 |
| Video | Picture Engine | UHD Up-Scaling | UHD Up-Scaling | UHD Up-Scaling | UHD Up-Scaling | UHD Up-Scaling |
| | Dynamic Contrast Ratio | Mega Contrast | Mega Contrast | Mega Contrast | Mega Contrast | Mega Contrast |
| | Micro Dimming | UHD Dimming | UHD Dimming | UHD Dimming | UHD Dimming | UHD Dimming |
| | Active Crystal Color | N/A | N/A | N/A | N/A | N/A |
| | Wide Color Enhancer (Plus) | N/A | N/A | N/A | N/A | N/A |
| | Auto Motion Plus | Yes | Yes | Yes | Yes | Yes |
| | Film Mode | Yes | Yes | Yes | Yes | Yes |
| Audio | Dolby Digital Plus | Yes | Yes | Yes | Yes | Yes |
| | DTS Codec | N/A | N/A | N/A | N/A | N/A |
| | Sound Output (RMS) | 20W(L:10W, R:10W) | 20W(L:10W, R:10W) | 20W(L:10W, R:10W) | 20W(L:10W, R:10W) | 20W(L:10W, R:10W) |
| | Speaker Type | 2CH(Down Firing w/ Bass Reflex) | 2CH(Down Firing w/ Bass Reflex) | 2CH(Down Firing w/ Bass Reflex) | 2CH(Down Firing w/ Bass Reflex) | 2CH(Down Firing w/ Bass Reflex) |
| | Bluetooth Audio | Yes | Yes | Yes | Yes | Yes |
| Smart Service | Smart TV Type | Smart | Smart | Smart | Smart | Smart |
| | Web Browser | Yes | Yes | Yes | Yes | Yes |
| | Smart View | Yes | Yes | Yes | Yes | Yes |
| Smart Feature | TV to Mobile - Mirroring | N/A | N/A | N/A | N/A | N/A |
| | Mobile to TV - Mirroring, DLNA | Yes | Yes | Yes | Yes | Yes |
| Differentiation | Sports Mode | N/A | N/A | N/A | N/A | N/A |
| | All Care Protection | N/A | N/A | N/A | N/A | N/A |
| Feature | Processor | Quad-Core | Quad-Core | Quad-Core | Quad-Core | Quad-Core |
| | Accessibility | Voice Guide(US English)/ Enlarge/ High Contrast/ Learn TV Remote(US English)/ Multi-output Audio | Voice Guide(US English)/ Enlarge/ High Contrast/ Learn TV Remote(US English)/ Multi-output Audio | Voice Guide(US English)/ Enlarge/ High Contrast/ Learn TV Remote(US English)/ Multi-output Audio | Voice Guide(US English)/ Enlarge/ High Contrast/ Learn TV Remote(US English)/ Multi-output Audio | Voice Guide(US English)/ Enlarge/ High Contrast/ Learn TV Remote(US English)/ Multi-output Audio |
| | Digital Clean View | Yes | Yes | Yes | Yes | Yes |
| | Auto Channel Search | Yes | Yes | Yes | Yes | Yes |
| | Auto Power Off | Yes | Yes | Yes | Yes | Yes |
| | Caption (Subtitle) | Yes | Yes | Yes | Yes | Yes |
| | ConnectShare™ (HDD) | Yes | Yes | Yes | Yes | Yes |
| | ConnectShare™ (USB 2.0) | Yes | Yes | Yes | Yes | Yes |
| | EPG | Yes | Yes | Yes | Yes | Yes |
| | Game Mode | Yes | Yes | Yes | Yes | Yes |
| | OSD Language | English, Spanish, French | English, Spanish, French | English, Spanish, French | English, Spanish, French | English, Spanish, French |
| | Picture-In-Picture | N/A | N/A | N/A | N/A | N/A |
| | BT HID Support | Yes | Yes | Yes | Yes | Yes |
| | USB HID Support | Yes | Yes | Yes | Yes | Yes |
| Teletext (TTX) | N/A | N/A | N/A | N/A | N/A | |
| System | Digital Broadcasting | ATSC/ClearQAM | ATSC/ClearQAM | ATSC/ClearQAM | ATSC/ClearQAM | ATSC/ClearQAM |
| | Analog Tuner | Yes | Yes | Yes | Yes | Yes |
| | CI (Common Interface) | N/A | N/A | N/A | N/A | N/A |
| | Data Broadcasting | N/A | N/A | N/A | N/A | N/A |
| Hospitality Feature | Samsung LYNK™ HMS Compatibility | Yes | Yes | Yes | Yes | Yes |
| | H.Browser | Yes | Yes | Yes | Yes | Yes |
| | Samsung LYNK™ REACH (IP) | REACH 4.0 | REACH 4.0 | REACH 4.0 | REACH 4.0 | REACH 4.0 |

SPECIFICATIONS

| MODEL | | 43NF69U HG43NF690UF | 50NF69U HG50NF690UF | 55NF69U HG55NF690UF | 65NF69U HG65NF690UF | 75NF69U HG75NF690UF |
|------------------------|---|----------------------------------|----------------------------------|----------------------------------|----------------------------------|----------------------------------|
| Hospitality Feature | Samsung LYNK™ REACH (RF) | REACH 4.0 | REACH 4.0 | REACH 4.0 | REACH 4.0 | REACH 4.0 |
| | Hospitality Home Menu | Home Menu 2017 | Home Menu 2017 | Home Menu 2017 | Home Menu 2017 | Home Menu 2017 |
| | Bluetooth Music Player (Mobile → TV) | Yes | Yes | Yes | Yes | Yes |
| | Hospitality Plug&Play (Easy Set-up) | Yes | Yes | Yes | Yes | Yes |
| | Auto Source Mode | Yes | Yes | Yes | Yes | Yes |
| | Power On Mode | Yes | Yes | Yes | Yes | Yes |
| | Hotel Channel List | Yes | Yes | Yes | Yes | Yes |
| | Channel Menu Display | Yes | Yes | Yes | Yes | Yes |
| | Mixed Channel List (ATSC, DVB-T/ T2/C/S2, Analog) | Yes | Yes | Yes | Yes | Yes |
| | My Channel | N/A | N/A | N/A | N/A | N/A |
| | Energy Saving Mode(BLU control) | Yes | Yes | Yes | Yes | Yes |
| | Logo Display with Time Out Setting (BMP/Movie) | Yes | Yes | Yes | Yes | Yes |
| | Welcome Message | Yes | Yes | Yes | Yes | Yes |
| | RJ12 / IR Pass Through | Yes | Yes | Yes | Yes | Yes |
| | External Clock Compatibility | N/A | N/A | N/A | N/A | N/A |
| | Clock Back Up Supply | Yes | Yes | Yes | Yes | Yes |
| | External Clock Dimming Control | N/A | N/A | N/A | N/A | N/A |
| | Software Clock | N/A | N/A | N/A | N/A | N/A |
| | Multi Code Remote control | Yes | Yes | Yes | Yes | Yes |
| | Sound Bar Compatibility | Yes | Yes | Yes | Yes | Yes |
| | Music Mode (Input: PC/AV/Component/HDMI) | Yes | Yes | Yes | Yes | Yes |
| | Music Mode Backlight on/off | Yes | Yes | Yes | Yes | Yes |
| | TTX Clock Update (Analogue) | N/A | N/A | N/A | N/A | N/A |
| | USB Cloning | Yes | Yes | Yes | Yes | Yes |
| | Smooovie Compatibility | Yes | Yes | Yes | Yes | Yes |
| | Soft AP | Yes | Yes | Yes | Yes | Yes |
| | On/Off Timer (Schedule) | Yes | Yes | Yes | Yes | Yes |
| | Alarm | Yes | Yes | Yes | Yes | Yes |
| | Samsung LYNK™ DRM RF | Yes | Yes | Yes | Yes | Yes |
| | Samsung LYNK™ DRM IP | N/A | Yes | Yes | Yes | Yes |
| | Pro:Idiom RF | Yes | Yes | Yes | Yes | Yes |
| | Pro:Idiom IP | N/A | Yes | Yes | Yes | Yes |
| bLAN | N/A | N/A | N/A | N/A | N/A | |
| Security Mode | Yes | Yes | Yes | Yes | Yes | |
| S/W EPG (Solution EPG) | Yes | Yes | Yes | Yes | Yes | |
| Input & Output | HDMI (Side/Rear) | 2/1 | 2/1 | 2/1 | 2/1 | 2/1 |
| | USB (Side/Rear) | 2/0 | 2/0 | 2/0 | 2/0 | 2/0 |
| | Component In (Y/Pb/Pr) (Side/Rear) | 0/1 | 0/1 | 0/1 | 0/1 | 0/1 |
| | Composite In (AV) (Side/Rear) | 0/1 (Common Use for Component Y) | 0/1 (Common Use for Component Y) | 0/1 (Common Use for Component Y) | 0/1 (Common Use for Component Y) | 0/1 (Common Use for Component Y) |
| | Ethernet (LAN) (Side/Rear) | 1 | 1/0 | 1/0 | 1/0 | 1/0 |
| | Headphone (Side/Rear) | N/A | N/A | N/A | N/A | N/A |
| | Audio Out (Mini Jack / LR) (Side/Rear) | 1/0 | 1/0 | 1/0 | 1/0 | 1/0 |
| | Digital Audio Out (Optical) (Side/Rear) | 1/0 | 1/0 | 1/0 | 1/0 | 1/0 |
| | RF In (Terrestrial/Cable input/Satellite Input) (Side/Rear) | 1/0 | 1/0 | 1/0 | 1/0 | 1/0 |
| | Ex-Link (RS-232C) (Side/Rear) | 1/0 | 1/0 | 1/0 | 1/0 | 1/0 |
| CI Slot (Side/Rear) | N/A | N/A | N/A | N/A | N/A | |

SPECIFICATIONS

| MODEL | | 43NF69U HG43NF690UF | 50NF69U HG50NF690UF | 55NF69U HG55NF690UF | 65NF69U HG65NF690UF | 75NF69U HG75NF690UF |
|------------------------------------|---|------------------------|------------------------|------------------------|------------------------|------------------------|
| Input & Output | Scart (Side/Rear) | N/A | N/A | N/A | N/A | N/A |
| | HDMI A / Return Ch. Support | Yes | Yes | Yes | Yes | Yes |
| | Wireless LAN Built-in | Yes | Yes | Yes | Yes | Yes |
| | Anynet+ (HDMI-CEC) | Yes | Yes | Yes | Yes | Yes |
| | Pillow Speaker Jack (Side/Rear) | N/A | N/A | N/A | N/A | N/A |
| | Variable Audio Out (Side/Rear) | 0/1 | 0/1 | 0/1 | 0/1 | 0/1 |
| | Variable Audio Out Volume Control (Side/Rear) | 0/1 | 0/1 | 0/1 | 0/1 | 0/1 |
| | Video Out (Side/Rear) | N/A | N/A | N/A | N/A | N/A |
| | RJ12 (Side/Rear) | 0/1 | 0/1 | 0/1 | 0/1 | 0/1 |
| | RJP (Remote Jackpack) (Side/Rear) | 1/0 | 1/0 | 1/0 | 1/0 | 1/0 |
| | Headphone ID (Side/Rear) | N/A | N/A | N/A | N/A | N/A |
| | Door-Eye Control (Side/Rear) | N/A | N/A | N/A | N/A | N/A |
| | Door-Eye Video In (Side/Rear) | N/A | N/A | N/A | N/A | N/A |
| | PC In (D-sub)(Side./Rear) | N/A | N/A | N/A | N/A | N/A |
| | PC/DVI Audio In (Mini Jack)(Side./Rear) | N/A | N/A | N/A | N/A | N/A |
| Ethernet-Out (LAN-Out) (Side/Rear) | 1/0 | 1/0 | 1/0 | 1/0 | 1/0 | |
| Design | Front Color | Black | Black | Black | Black | Black |
| | Stand Type | Square | Square | Square | Square | Y-Shape |
| | Swivel (Left/Right) | Yes(90/90) | Yes(90/90) | Yes(90/90) | Yes(90/90) | N/A |
| Dimension (WxHxD) | Set Size without Stand (WxHxD) (mm) | 975.8x569.0x62.6 | 1128.9x654.4x63.2 | 1242.6x718.4x63.2 | 1463.5x844.5x64.6 | 1688.9x971.2x66.0 |
| | Set Size with Stand (WxHxD)(mm) | 975.8x626.4x226.5 | 1128.9x711.6x226.5 | 1242.6x775.3x226.5 | 1463.5x923.4x355.1 | 1688.9x1052.6x384.9 |
| | Package Size (WxHxD)(mm) | 1180.0x674.0x161.0 | 1361.0x760.0x164.0 | 1462.0x833.0x184.0 | 1760.0x977.0x210.0 | 1886.0x1138.0x258.0 |
| Weight | Set Weight without Stand (kg) | 8.7 | 12.7 | 14.7 | 23.8 | 35.2 |
| | Set Weight with Stand (kg) | 11.8 | 15.8 | 17.8 | 28.9 | 38.8 |
| | Package Weight (kg) | 15.9 | 20.8 | 24.4 | 38.5 | 53.2 |
| Accessory | Remote Controller Model | TM1240A | TM1240A | TM1240A | TM1240A | TM1240A |
| | Battery (for Remote Control) | Yes | Yes | Yes | Yes | Yes |
| | Samsung Smart Control (Included) | N/A | N/A | N/A | N/A | N/A |
| | Mini Wall Mount Support | Yes | Yes | Yes | Yes | N/A |
| | Vesa Wall Mount Support | Yes | Yes | Yes | Yes | Yes |
| | Power Cable | Yes | Yes | Yes | Yes | Yes |
| | Quick Install Guide | Yes | Yes | Yes | Yes | Yes |
| | Data Cable | Yes | Yes | Yes | Yes | Yes |
| | Stand Mount Kit | Yes | Yes | Yes | Yes | Yes |
| | Stand Security Screws | Yes | Yes | Yes | Yes | Yes |
| Angle Adaptor (for Side RF tuner) | N/A | N/A | N/A | N/A | N/A | |
| VESA Standard | VESA Size | 200x200 | 400x400 | 400x400 | 400x400 | 400x400 |
| | Wall Mount Screw Size | M8 | M8 | M8 | M8 | M8 |

SPECIFICATIONS

HG43NF690UF

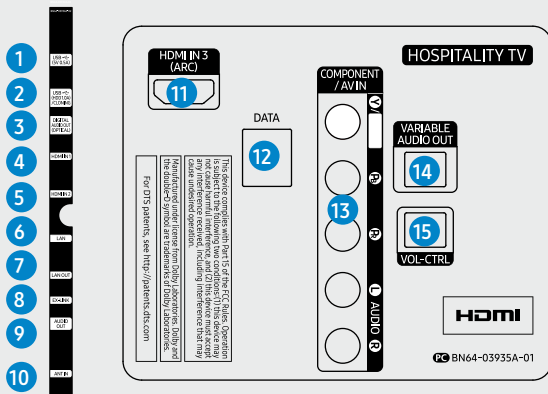
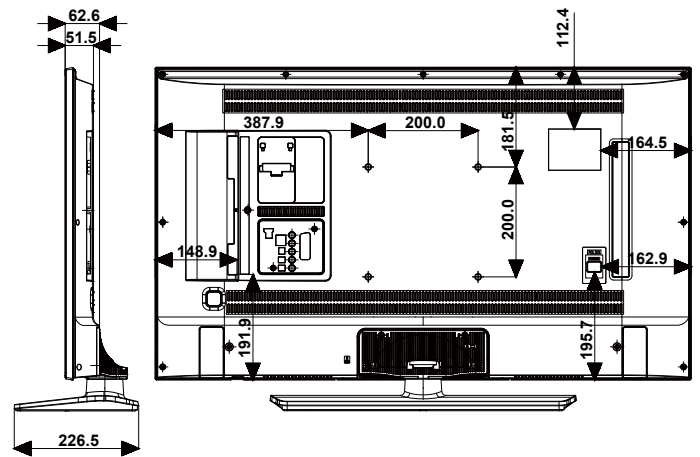
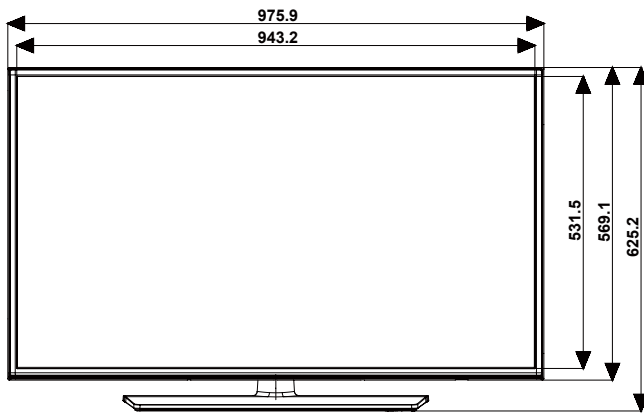

CONNECTORS

- | | |
|-------------------------------|------------------------|
| 1. USB(5V 0.5A) | 12. DATA |
| 2. USB(HDD1.0A) / CLONING | 13. COMPONENT / AV IN |
| 3. DIGITAL AUDIO OUT(OPTICAL) | 14. VARIABLE AUDIO OUT |
| 4. HDMI IN1 | 15. VOL-CTRL |
| 5. HDMI IN2 | |
| 6. LAN | |
| 7. LAN OUT | |
| 8. EX-LINK | |
| 9. AUDIO OUT | |
| 10. ANT IN | |
| 11. HDMI IN3 (ARC) | |

HG50NF690UF

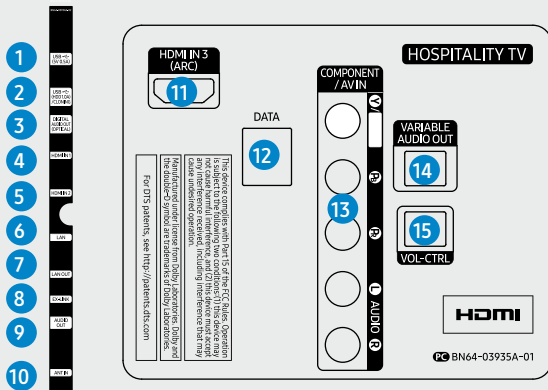
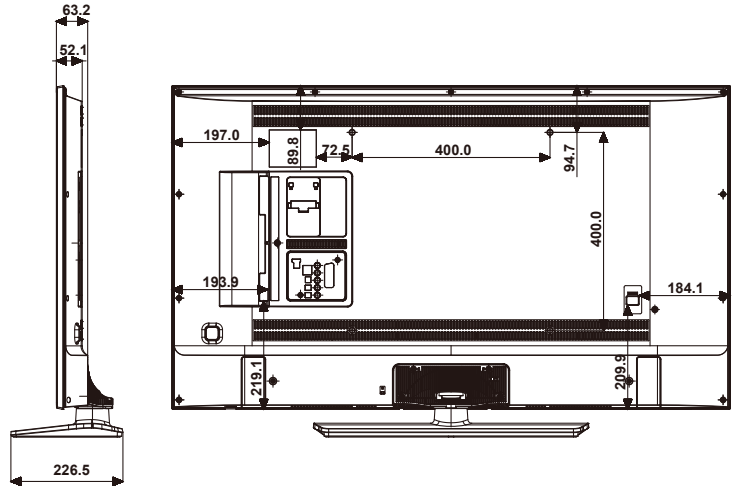
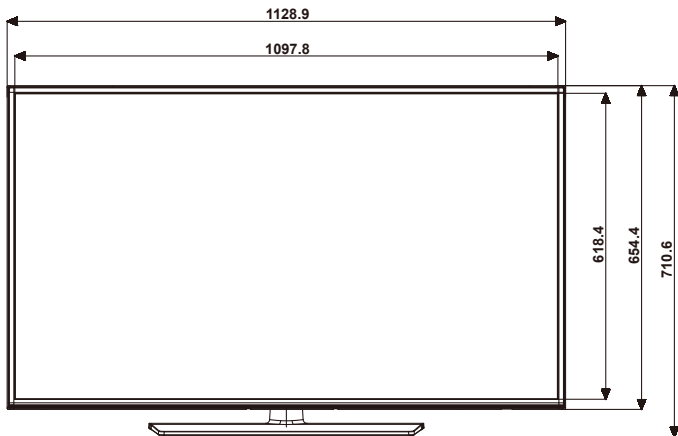

CONNECTORS

- | | |
|-------------------------------|------------------------|
| 1. USB(5V 0.5A) | 12. DATA |
| 2. USB(HDD1.0A) / CLONING | 13. COMPONENT / AV IN |
| 3. DIGITAL AUDIO OUT(OPTICAL) | 14. VARIABLE AUDIO OUT |
| 4. HDMI IN1 | 15. VOL-CTRL |
| 5. HDMI IN2 | |
| 6. LAN | |
| 7. LAN OUT | |
| 8. EX-LINK | |
| 9. AUDIO OUT | |
| 10. ANT IN | |
| 11. HDMI IN3 (ARC) | |

SPECIFICATIONS

HG55NF690UF

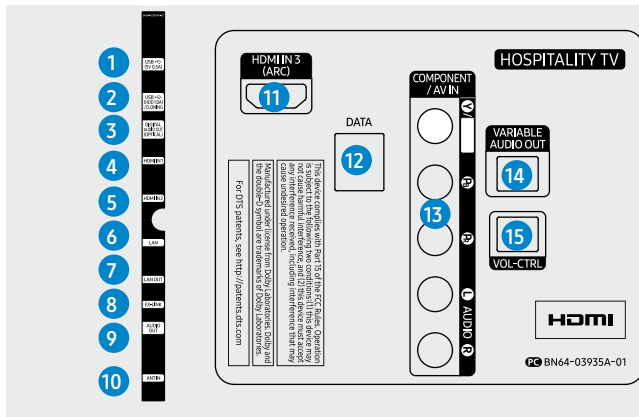
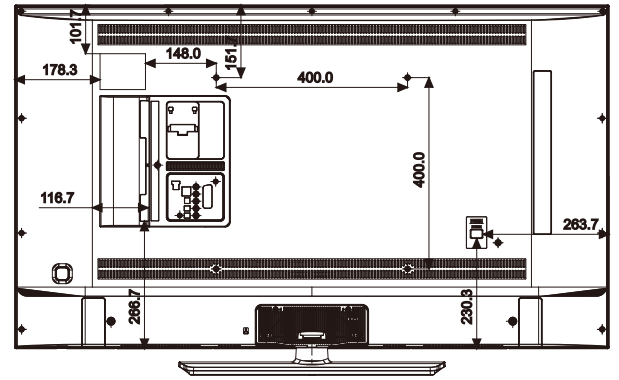
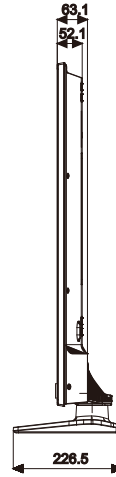
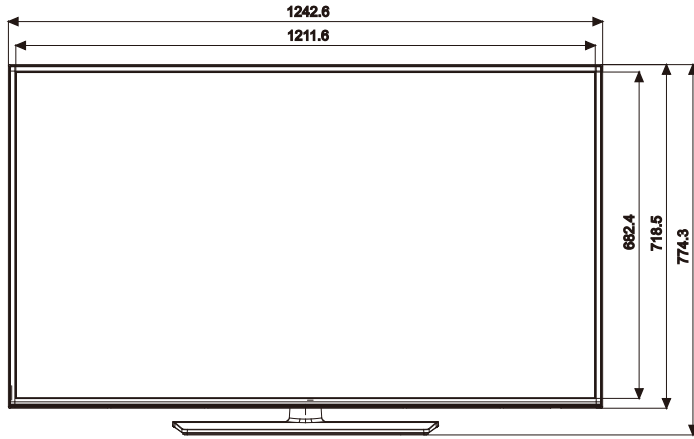

CONNECTORS

- | | |
|-------------------------------|------------------------|
| 1. USB(5V 0.5A) | 12. DATA |
| 2. USB(HDD1.0A) / CLONING | 13. COMPONENT / AV IN |
| 3. DIGITAL AUDIO OUT(OPTICAL) | 14. VARIABLE AUDIO OUT |
| 4. HDMI IN1 | 15. VOL-CTRL |
| 5. HDMI IN2 | |
| 6. LAN | |
| 7. LAN OUT | |
| 8. EX-LINK | |
| 9. AUDIO OUT | |
| 10. ANT IN | |
| 11. HDMI IN3 (ARC) | |

HG65NF690UF

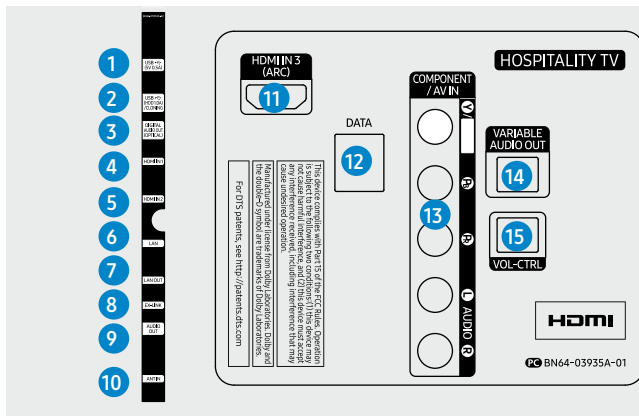
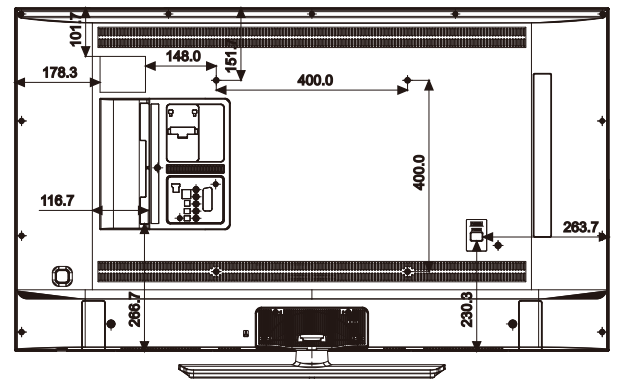
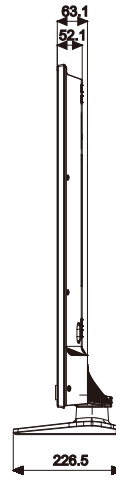
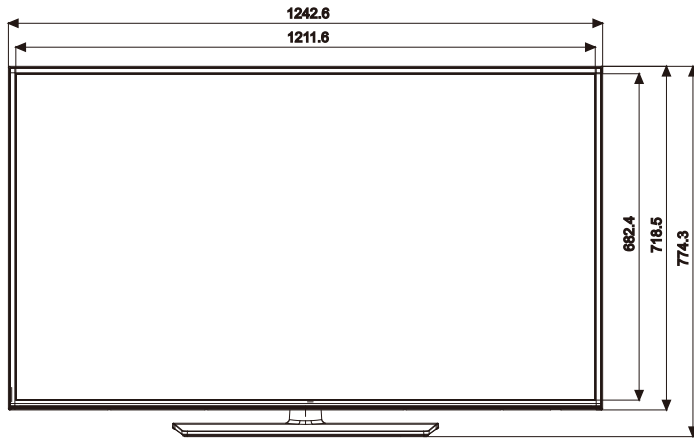

CONNECTORS

- | | |
|-------------------------------|------------------------|
| 1. USB(5V 0.5A) | 12. DATA |
| 2. USB(HDD1.0A) / CLONING | 13. COMPONENT / AV IN |
| 3. DIGITAL AUDIO OUT(OPTICAL) | 14. VARIABLE AUDIO OUT |
| 4. HDMI IN1 | 15. VOL-CTRL |
| 5. HDMI IN2 | |
| 6. LAN | |
| 7. LAN OUT | |
| 8. EX-LINK | |
| 9. AUDIO OUT | |
| 10. ANT IN | |
| 11. HDMI IN3 (ARC) | |

SPECIFICATIONS

HG75NF690UF

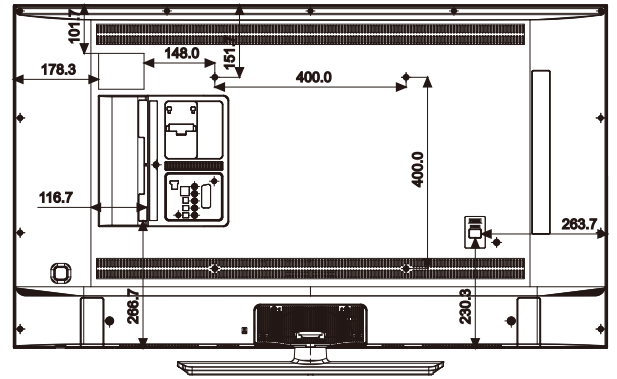
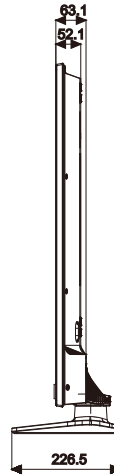
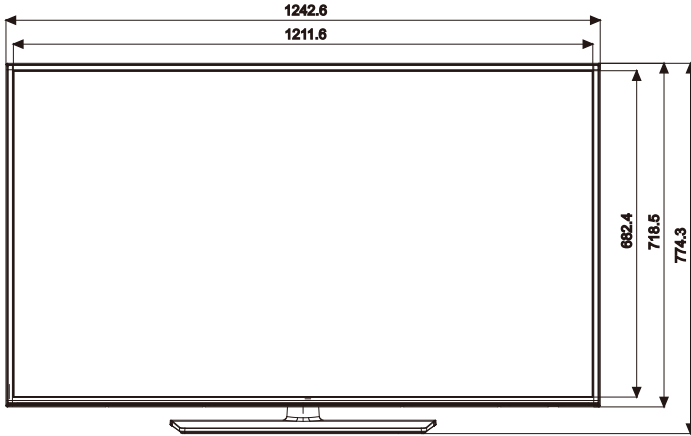

- 1
- 2
- 3
- 4
- 5
- 6
- 7
- 8
- 9
- 10

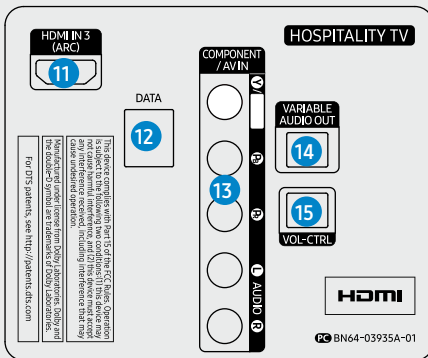

CONNECTORS

1. USB(5V 0.5A)
2. USB(HDD1.0A) / CLONING
3. DIGITAL AUDIO OUT(OPTICAL)
4. HDMI IN1
5. HDMI IN2
6. LAN
7. LAN OUT
8. EX-LINK
9. AUDIO OUT
10. ANT IN
11. HDMI IN3 (ARC)
12. DATA
13. COMPONENT / AV IN
14. VARIABLE AUDIO OUT
15. VOL-CTRL

ABOUT SAMSUNG ELECTRONICS CO., LTD.

Samsung Electronics Co., Ltd. inspires the world and shapes the future with transformative ideas and technologies. The company is redefining the worlds of TVs, smartphones, wearable devices, tablets, cameras, digital appliances, medical equipment, network systems, and semiconductor and LED solutions. For the latest news, please visit Samsung Newsroom at <http://news.samsung.com>

HOSPITALITY DISPLAY

For more information about Samsung Hospitality Displays, visit www.samsung.com/business or www.samsung.com/displaysolutions

Copyright © 2017 Samsung Electronics Co. Ltd. All rights reserved. Samsung is a registered trademark of Samsung Electronics Co. Ltd. Specifications and designs are subject to change without notice. Non-metric weights and measurements are approximate. All data were deemed correct at time of creation. Samsung is not liable for errors or omissions. All brand, product, service names and logos are trademarks and/or registered trademarks of their respective owners and are hereby recognized and acknowledged.

Samsung Electronics Co., Ltd.
416, Maetan 3-dong, Yeongtong-gu
Suwon-si, Gyeonggi-do 443-772, Korea

2017-08



Scan this code with your smartphone to download the Samsung Display Solutions Mobile App.